



ROAD WORK AHEAD **CATALOG**

208-734-4444

729 Commerical Ave. Twin Falls, ID 83301

www.roadworkaheadonline.com

2

0

2

1

TABLE OF CONTENTS

<u>Allstate Coatings</u>	26
<u>Barricades</u>	19
<u>Billy Goat</u>	6
<u>Squeegees</u>	40
<u>Cleaners</u>	32
<u>Cones</u>	8
<u>Crackfiller Melters (Direct Fire)</u>	5
<u>Dicke Apparel</u>	16
<u>Dicke Vests</u>	15
<u>ERB Hard Hats</u>	13
<u>Flags and Signs</u>	33
<u>Geotextile</u>	31
<u>Keson</u>	22
<u>Lights and Flares</u>	24
<u>Little Wonder</u>	7
<u>Miscellaneous</u>	44
<u>ML Kishigo</u>	12
<u>New Items & Rental Equipment</u>	4
<u>Road Maintenance Equipment</u>	30
<u>Roadside Equipment</u>	29
<u>Scorpion Equipment</u>	28
<u>Sealcoat</u>	37
<u>Shovels</u>	41
<u>Sign Equipment</u>	34
<u>Snow Removal</u>	10
<u>Brooms</u>	38
<u>Survey Equipment</u>	20
<u>Thermoplastic</u>	36
<u>Twin Falls Signs</u>	46
<u>Yellowstone Gloves</u>	14

ABOUT US



A Privately Owned Idaho-Based Company

Road Work Ahead Construction Supply has been in business since 2001. We manufacture sealcoat and offer a wide range of sealcoat supplies. We also provide traffic control services and supplies. If you need to add signs to your jobsite we offer custom traffic signs with an extremely fast turn-around time.

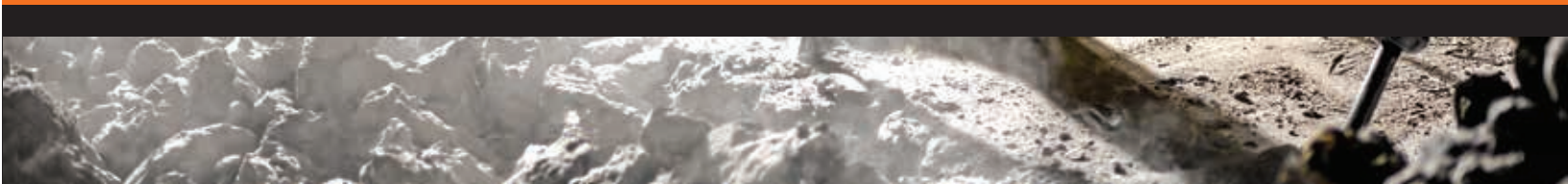

NEW ITEMS & RENTAL EQUIPMENT

Asphalt Line Eraser

Line Removal with little damage to the asphalt.



Asphalt Scarifier

For leveling and cleaning out cracks.



Pavement Slot Router

For evening and cleaning out cracks.



Bensink Rotary Broom

Used for high power sweeping.



800 Series Vers-A-Striper

Lightweight, aerosol stripping applicator.



HP1550 Honda Plate Compactor

For small scale compacting.



CRACKFILLER MELTERS (DIRECT FIRE)

30 Gallon Melter



- 30 gallon capacity
- Regulator, hose, and torch
- Hand operated agitator
- Manufactured in the USA

10 Gallon Melter Applicator

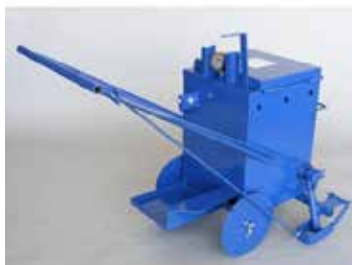

- 10 gallon capacity
- Includes regulator, hose, and torch
- Walk and pour design
- Truck or trailer mount capability
- Built in leveler
- Manufactured in the USA

2.6 Gallon Pour Pot With Legs



- 2.6 gallon capacity
- Hand held
- Walk and pour design
- 3/8" NPT nozzle
- Manufactured in the USA

BILLY GOAT

F6 Small Property/ Residential



These models are 30% lighter than comparable steel units and weigh only 76 lbs making them a breeze to roll around. Rounded composite housing which eliminates air voids, reduces noise, lighter weight, and pushes the design stress on the engine shaft for longer life.

F9 & F13 Contractor/ Municipal



Professional power and productivity, this Honda powered unit is a favorite for full size landscapers, seal coaters, schools, parks departments, cemeteries, resorts, street departments, golf, and estate properties.

F18 The Ultimate



The ultimate in volume and power! A 6" discharge with air velocity of just below 200 mph will blow and push leaves and debris further so you can clean up faster than with any other blower in the Billy Goat products.

LITTLE WONDER

Push Blowers



- Self-propelled up to 4.1 mph forward and 2.5 mph reverse
- Large, square discharge chute is low to the ground for better blowing power
- Scrolled housing ensures consistent, constant airflow even if partially blocked by leaves
- Ergonomic handle design; height adjustable with anti-vibration grip
- Unique split-stream air deflector moves piles of leaves further and faster
- Remote discharge chute control on the handle at your fingertips
- Transport bracket for convenient tie-down during transport.

Available Sizes:
5HP Honda
6.5HP Briggs
9HP Subaru
9HP Honda
13HP Honda
18HP Vanguard

Pro Vac



- Powered to perform. Powerful Briggs & Stratton® Vanguard engine
- Industry-leading suction. Top in airflow for the past 20 years
- Top loading. Fills debris bag completely without loss of suction
- 74.47 gallon capacity bag for handling big loads
- Low 40" unit height allows for clear visibility over the machine and better view of the front nozzle area
- Operator comfort. Arched padded handle allow users of any size to find a comfortable operating position
- Nozzle height automatically adjusts – no need to stop the engine and change height settings to avoid ‘scalping’ and ‘digging in’ on rough terrain

Pro Crack Cleaner Honda 4HP



- Dual belt drive provides extra power to the brush and reduces slippage during application
- Brush depth adjustable up to 4 inches
- Brush shield keeps debris off the belts
- Anti-vibration grip for user comfort
- Large heavy-duty 9" diameter twisted wire wheel brush

CONES

Candle



- Bright orange color molded throughout
- UV inhibitors to minimize fading
- Bases will not crush when run over
- Meets federal MUTCD standards
- Made of flexible low density polyethylene
- Measures 42" in height

Cone



- We have available sizes 12", 18", and 28"
- Broad base for stability
- Heat resistance to 160°
- Meet MUTCD and FHWA requirements
- One-piece, flow-molded polyvinyl chloride
- Anti-fade, fluorescent orange color

Enviro-Cone



- 28" tall with 3M reflective collars
- 80% recycled
- Low density polyethylene
- 80% of weight in the base creates better stability
- Reusable bases for new stems

Surface Mount Delineator



- 36" in height with 8" in base
- High density polyethylene
- Temperature resistant from 20-120 F
- Flexible post with base
- 3M Reflective stripping
- Excludes butyl pads

Soil Mount Delineator



- Can be ordered in red, yellow, white, Blue, green, and orange
- Reflective 3M stripping at the top
- Height in 19" 24" 30" 36" 48" 60"
- Can withstand 10 impacts at 55 mph to 4' posts
- Meets DOT specification

Drum



- Drum is a minimum of 18" by 36" height
- Tapered design allows stacking
- Gentle curves throughout drum eliminate sharp edges or corners that crack and break when impacted
- Two mounting holes for optional barricade lights
- Bright orange color molded throughout drum
- UV inhibitors minimize fading
- NTPEP tested-meets or exceeds MUTCD specifications
- Retaining lip and flange for added strength during impact
- 100% recycled rubber base for increased durability resisting movement from passing vehicles

Carsonite Delineation



- Provides bright delineation of roadway edge-lines and medians
- Polycarbonate post bends on impact to prevent breakage
- UV stabilized so it won't discolor, rust, rot or splinter
- Features a point tip to easily install in the ground
- Built tough to endure multiple high speed impacts
- Can be ordered in white, orange, red, green, blue, and yellow
- Reflective 3M striping at the top

SNOW REMOVAL

Peladow



Helps make steps, sidewalks, driveways, and parking lots safer. Continues working up to -25F. Bores through ice up to 3 times faster than flat or crystal-shaped ice melters. Product also stays in desired location without it tracking on your feet.

Liquid Calcium Chloride



At 25F (4C), rock salt takes a full 19 minutes to embed in ice and hard packed snow. Wetted with a 32% calcium chloride solution, rock salt immediately digs in and holds a close pattern on winter roads even when temperatures drop down to 0F (18C). Wetted salt reduces the need for frequently repeated applications, decreasing material use by as much as 40%.

Road Work Ahead and Sage Supply provide liquid calcium chloride tanks and refill them as needed throughout the season. Making sure you always have what you need on hand.

Liquid Calcium Chloride Tank



Helps make steps, sidewalks, driveways, and parking lots safer. Continues working up to -25°F. Bores through ice up to 3 times faster than flat or crystal-shaped ice melters. Product also stays in desired location without it tracking on your feet.



These models are 30% lighter than comparable steel units and weigh only 76 lbs making them a breeze to roll around. Rounded composite housing which eliminates air voids, reduces noise, lighter weight, and pushes the design stress on the engine shaft for longer life.

250 Gallon Truck Mount Tank



Calcium chloride truck bed spray set up for de-ice or dust abatement with spray bar.

Hiniker Snow Plow



Please call for availability and size options.

ML KISHIGO

1515 Black Series Black Bottom Safety Vest - Yellow/Lime



- Ultra-Cool 100% polyester mesh with heavy duty black bottom and trim to keep vest appearance clean and professional
- Zipper front closure with durable webbing reinforcement
- 2" wide silver laminated reflective material with 3" breathable contrasting color
- Reflective trim around arms and piping down sides for added low light visibility
- Left and right chest mic tabs

S5004 High Performance Safety Vest - Yellow/Lime



- Ultra-Cool 100% polyester mesh
- Zipper front closure with durable webbing reinforcement
- 2" wide high performance reflective material with 3" contrasting black
- Left and right mic tabs
- Padded neck for comfort

S5014 High Performance Class 3 Safety Vest - Yellow/Lime



- Ultra-Cool 100% polyester mesh
- Zipper front closure reinforced with durable webbing
- 2" wide high performance reflective material
- Left and right mic tabs
- Padded neck for comfort

ERB HARD HATS



Molded from high density polyethylene. Provides protection from sun and rain.
Secure-Fit ratchet features. Adjusts to head sizes, 6 1/2 - 8. Made in USA.
Meets ANSI Z89.1 Type 1 Class C, E & G requirements.

Road Work Ahead and Sage Supply provides hard hats in full brim and half brim.
Also in Neon Orange, Neon Green, Neon Pink, and White.

Hi-Viz Lime Mesh Neck Shield



Ultra-light weight
100% polyester mesh neck
shield. Attaches to the brim of
all ERB safety cap style and
full brim style helmets.

YELLOWSTONE GLOVES

Black Nitrile Tough



- Knit wrist
- Seamless knit black nylon dipped
- Durable
- Available in M, L and XL

Bald Eagle Thinsulate Insulation



- Synthetic fiber in the palm area that is lightweight, washable, and breathable.
- Velcro closure
- Neoprene knuckles with a curved finger design
- Long lasting durability
- Insulated
- Available in M, L, XL, and 2XL

Blue Latex Coated



- Blue crinkle latex palm coating increases grip while wet or dry
- Grey cotton with polyester seamless knit shell
- Excellent wear, resistance, and flexibility
- Long knit cuff for a secure fit and increased protection
- Fingers are pre-curved to minimize hand fatigue
- Available in M, L, and XL

Rocky Mountain Gloves



- Grain cowhide
- Color coded hem indicates sizing
- Elastic enforced wrist
- Available in S, M, L, XL, 2XL

Bald Eagle Pigskin Palm



- A grade beige pigskin palm
- Velcro closure
- Blue stretch back with neoprene knuckles
- Designed to follow the contour of your hand
- Available in sizes M, L, XL, 2XL

Thinsulate Insulation



- Traps and holds body heat
- Won't absorb water
- Safety cuffs
- Thinsulated lining
- Available in large.

Kinco Frost Breaker



- Durable blue crinkle latex coated palm
- Locks in warmth
- Wicks away moisture
- Available in sizes S, M, and L

DICKE VESTS

V155 – Mesh



- ANSI Class 3.
- Lime mesh polyester material.
- 2" reflective silver w/orange triple trim contrasting stripes.
- Expandable radio pocket, outside zipper pocket, large 5" x 7" inside pocket, and pencil pocket.
- Zipper closure.
- Sizes: M-7XL

V1300 – Mesh



- ANSI Class 2.
- Lime mesh polyester material.
- 2" reflective silver w/orange triple trim contrasting stripes.
- Expandable radio pocket, outside zipper pocket, large 5" x 7" inside pocket, and pencil pocket.
- Zipper closure.
- Sizes: M-5XL

V300 Safety Vest



- ANSI Class 2.
- Lime solid polyester material.
- 2" reflective silver stripes.
- Outside zipper pocket, pencil pocket, and large 5" x 7" inner pocket.
- Zipper closure.
- Sizes: M-5XL

V30 Safety Vest



- ANSI Class 2.
- Lime mesh polyester material.
- 2" reflective silver stripes.
- Hook and loop closure.
- Sizes: M-5XL

DICKE APPAREL

Hi-Viz Knitted Cap



- 100% soft acrylic knitted fabric.
- 360 degree reflective strip made of polyester reflective yarn for added visibility.
- Hi-viz lime color.
- One size fits all.

J3201 Bomber Jacket



- Meets ANSI 107-2010 Class 3 standards.
- Dual orange over lime color for maximum visibility.
- Weather resistant polyurethane coated fabric.
- Permanent fleece liner, fleece lined side pockets.
- Zip out drawstring hood.
- 2" retro reflective silver stripes.
- Inside breast and pencil pocket, radio pocket.
- Zipper plus hook and loop closure.
- Sizes: M-5XL

J5200 Parka



- Meets ANSI 107-2010 Class 3 requirements.
- Hi-viz orange and lime over blue maximizes visibility.
- 2" wide reflective silver stripes.
- Weather resistant polyurethane coated fabric.
- Quilted inside liner, zip-out drawstring hood.
- Expandable outside breast pocket.
- Two large outside pockets have top flaps with hook and loop closure.
- Two large inside pockets and inside pencil pocket.
- Drawstring bottom cinches tight for warmth.
- Sizes: M-5XL

SS150/ SS250



- Meets ANSI 107-2010 Class 3 requirements.
- Two styles: Pullover and Zipper.
- Polyester lined sleeves for easy pull-on and pull-off.
- Black lower front color prevents dirt and grime from showing.
- Hood is sewn flat at the crown providing comfort when worn with hard hat.
- Front pouch pocket.
- Heavy duty stitching with rib knit cuffing.
- 2" reflective silver stripes in Class 3 configuration.
- Pullover Style: Lime/Black - SS150, Orange/Black - SS250.
- Zipper Style: Lime/Black - SZ150.
- Sizes: M-5XL

J3300 Bomber Jacket Black Bottom



- Meets ANSI 107-2010 Class 3 requirements.
- Polyester lined sleeves for easy pull-on and pull-off.
- Black lower front color prevents dirt and grime from showing.
- Heavy duty stitching with rib knit cuffing.
- 2" reflective silver stripes in Class 3 configuration.
- Zipper Style: Lime/Black
- Sizes: M-5XL

J4211 Bomber Jacket and Liner Combo



- Meets ANSI 107-2010 Class 3 standards.
- Dual orange over lime color for maximum visibility.
- Weather resistant polyurethane coated fabric.
- Removable Class 3 fleece liner with pockets.
- Zip out drawstring hood.
- 2" retro reflective silver stripes.
- Side pockets and radio pocket.
- Zipper plus hook and loop closure.
- Sizes: M-5XL

BARRICADES

Line Guides

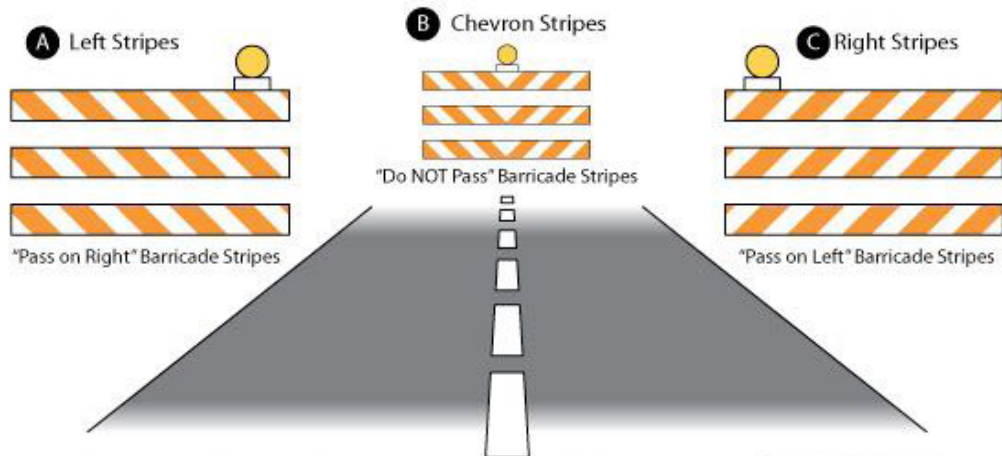

NOTE: The "Chevron" barricade beam can be flipped around like this...  When displayed like that, you would be indicating that it is OK to "PASS ON EITHER SIDE".

Economy type III

These barricades can be assembled and disassembled in a matter of minutes by a single person. With Phoenix plastic rails, provides low cost type III solution with rolled steel uprights and feet.



A-Frame & Rails

Our type I is made of rigid impact resistant polyethylene and the legs are sand fillable for ballasting, stackable for storage, and transportation.



Reflective Tape

3M flexible prismatic striped barricade sheeting.
6", 7.75", 8", 10", 12", 24"
Purchase by the roll or Linear Foot.



Type I & II Folding Barricades

Our plastic folding barricades are made from durable polyethylene. The lightweight and easy to handle traditional metal type II's consist of steel legs and wafer board.



Black Rubber with Yellow Stripes

6'L X 4"H X 6"W 4 bolts and nuts not included



Jersey Baricade

10' x 32"
2 enforced loops on each side
Can accommodate barricade tape with additional fees



Cement Blocks

Size 6'L X 5"H X 9"W
Includes 2 railroad stakes and 2 hole caps
Available in gray, blue, green, and yellow



SURVEY EQUIPMENT

Hubs & Stakes

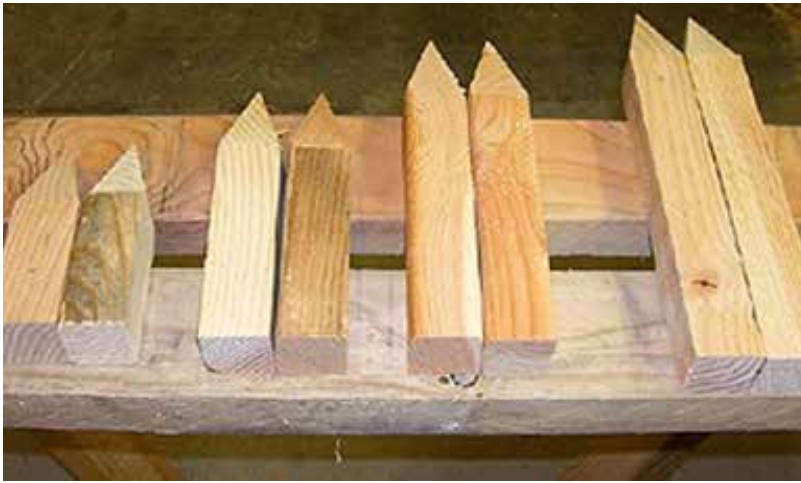

Hubs: We make 6", 8", 10", 12", 14", 16", 18", and 24". Our 6" and 8" comes in 50 count and the rest comes in 25 count

Stakes: 6", 8", 10", 12", 14", 16", 18", and 24". Our 6" and 8" comes in 100 count

Lath: 1/2"x 48", 50 count bundle

Marking Paint

- Mark will last up to 6 months
- Non-freezing
- Operational to 14°F (-10°C)
- H.D. = high delivery (30% greater than other colors)
- Colors meet standards set by OSHA and APWA/One Call Systems
- Container Size: 20 oz.
- Net Weight: 17 oz.
- Case Pack: 12



Striping Paint

- Solvent-based formula designed to adhere to a variety of surfaces, especially asphalt and concrete.
- Fast drying: 5 minutes to touch
- Durable, long-lasting stripe
- High-visibility colors
- VOC compliant and lead-free
- Container Size: 20 oz.
- Net Weight: 18 oz.
- Case Pack: 12



Marking Chalk

- A special blend of materials, safe for use on all surfaces in an upside-down marking can. Temporary mark lasts 10-20 days.
- Container Size: 20 oz.
- Net Weight: 15 oz.
- Case Pack: 12



Marking Stick



- For stenciling and touch-up striped lines. Use with Aervoe striping paints only.
- Approximately 36" long.
- Retention clip prevents movement of can once can is activated.
- Sturdy wheel stabilizes and helps control markings
- The striping stick is designed for use with inverted striping paint. The can should always be used in an inverted position.

Vers-A-Striper



- A lightweight, yet heavy-duty aerosol striping paint applicator.
- For use on hard surfaces such as asphalt and concrete
- Stripe widths up to 4"
- Includes a striping alignment guide

Survey Ribbon



- Colorful and highly visible Solid & GLO Colors
- Long lasting and durable colors
- 1" x300" solid color
- 1" x150" GLO color
- 1" x300" white and black polka

Marking Flags



- Marking flags polyethylene Flags with a sturdy 18 gauge steel wire staff
- Available in solid or GLO colors
- 2"x3"x21"

Survey Whiskers



Survey Whiskers: 6 inches long, bundles of 25 or cases of 1000. Maximum visibility and can withstand multiple passes of a grader blade.

KESON

Tape Measure

- Nylon coated steel blade
- True zero hook
- Bumper cushion
- Belt clip
- Easy-to-read graduations
- Positive locking button
- Heavy-duty end hook
- 3 rivet Hook



Chalk Reels

- 100ft. and 150ft. chalk reels
- Holds over 1 pound of chalk for fewer refills
- One-piece steel crank for long life
- Leaves huge bold lines
- Made in USA
- Case Pack: 12



High Visibility Chalk

- For exterior and interior use
- Standard chalk and high visibility chalk can wash away naturally in a few days
- Can be ordered in 8oz, 3lbs, 5lbs, 25lbs, and 48lbs.
- Comes in white and glo-orange



PROChalk Permanent

- For exterior and interior use
- Engineered to withstand water, weather, and is long lasting
- Can be ordered in 8oz, 3lbs, 5lbs, 25lbs, 48lbs.



Lumber Chalk

- Ideal for warmer climates, and for marking on dry and wet wood, paper, cartons, stone, concrete, tiles, and plastic. Weather and wear resistant.
- Case Pack: 12



MEASURING WHEELS

MP401E



- Electronic wheel with steel frame
- Secure “thumb-up” grip ensures less wrist strain
- Magnetic pick-up avoids dust, dirt, and other particle disturbance
- Sealed counter encasement
- Meets NEMA Class II standards
- Waterproof
- Easy-to-read digital counter

MP401



- 4' circumference wheel levels out uneven ground
- Rugged 3/4" steel frame-tough enough to hold any terrain
- Compact fold down
- Innovative design-simple, center-line functionality.
- Great balance
- Metal shelf keeps dirt and debris from coming into contact with the counter

MP301



- 3' circumference wheel levels out uneven ground
- Rugged 3/4" steel frame-tough enough to hold any terrain
- Compact fold down
- Innovative design-simple, center-line functionality.
- Great balance
- Metal shelf keeps dirt and debris from coming into contact with the counter

RRT12



- Pistol-type handle increases control and comfort
- Re-set on the handle AND on the unit housing
- Brake on pistol grip
- Collapsing hinge
- Compact fold-down
- Flip-down kickstand (3 foot size)

LIGHTS AND FLARES

Universal Road Flare 6-pack Kit

Contains 6 extremely durable, rechargeable 18-LED flares that are a safe alternative to incendiary flares.

These flares are smokeless, flameless, non-toxic, waterproof, crushproof and come with an impact resistant rubber housing. Visible up to 1 mile.

The charging/storage kit is a durable transport case that not only stores the flares but keeps them charged for use when needed.

The kit may be plugged into a 12V vehicle power receptacle or 120V electrical wall socket. Both methods are included. Made In the USA!



Type A, C, or D-Cell LED Sundowner

- Popular "D" cell battery.
- Extra light intensity
- Three modes are available - flash, steady, and off.
- Changing from a flashing type "A" to a steady burn type "C" and back is simple with push on the mode switch.
- Meets the May 2001 ITE purchase specification.
- Blinks at Night
- Bidirectional Visibility
- Equipped with a photocell which turns light on and off at dawn and dusk.



Type B Solar and D-cell Sundowner

- Exceeds ITE standards and MUTCD visibility specifications
- Will operate on 4 D-cell batteries, solar charging cells, or a combination of both.
- Three modes of operation, Flash, Steady-Burn, and Off.
- Optically correct polycarbonate lens, high impact case, and stainless steel contacts.
- Tested by a Coast Guard approved laboratory.
- Lightweight, may be self-certified for compliance with NCHRP
- 350 crash test standards
- Bidirectional Visibility



Highlighter LED



- Low profile; only 2.7-inches tall and 15-inches long
- Uniform 360-degree light distribution; no dark spots or shadows
- Solaris® LED reflector technology for better optical efficiency and superior off-axis warning
- Pattern selection using MagnetSelect™ (keychain not included).

Firebolt LED Class 3 Model



- Single flash pattern
- (3) high-powered LEDs
- Cost effective
- Permanent and magnet mount models available
- Polycarbonate base and dome

Pulsator LED



- (14) selectable flash patterns
- Federal Signal's patented pattern Power Select™ feature
- Built-in permanent/pipe mount base
- Magnet mount and suction-cup magnet mount models with cigarette plug with on/off switch available
- Polycarbonate base and dome

Micropulse



- Low-profile for discreet mounting
- Models available for hood, grille, and surface mount applications
- Superior warning with high-power LEDs
- Solid and dual color models available
- Single/multi-unit synchronization
- Multi-voltage input of 12/24 VDC
- Brackets available for multiple mounting options
- Protection against dust and water

ALLSTATE COATINGS

Poly Oil Sil



A quick drying modified barrier coating, formulated to coat and promote adhesion over oil, grease and gasoline spots or chemical stains prior to the application of refined coal tar and asphalt sealer on asphaltic surfaces.

Can be used over all types of hot patched areas or oil contaminated cracks. It is easy to use on parking lots, driveways, airport runways, traffic safety islands or any asphalt or concrete surface

Flex-Crac



A rubberized asphalt emulsion with greater flexibility designed for sealing narrow pavement cracks up to 1" in width, in asphalt and concrete surfaces. It has resilient characteristics that can allow self-threading or memory. It has excellent flow properties and no pin holing. It is ready to use and available in a 1 Gallon Jug or 5 Gallon Pail.

Black Elixir



Black Elixir Sealing Additive is a specially blended copolymer emulsion containing fast drying chemicals which modify asphalt sealers to achieve up to 80% faster curing time, outstanding toughness and adhesion, better suspension of the aggregates, deeper jet black color, and resistance to oils, fuels, grease and chemicals.

Flex-Crete

Flex Crete can be used in all typical concrete joint/seam or crack applications in most climates and is compatible with asphalt pavement. Flex Crete is a gray single-component, ready-to-use, ultra-low modulus, pourable, neutral cure elastomeric emulsion which offers the performance and durability characteristics of conventional silicone but is not a silicone or polyurethane based product. It provides a lasting and flexible seal with the ease of installation of self-leveling pourable materials.



Gator-Aid

Gator-Aid is a blend of an asphaltic emulsion, mineral fillers, fibers, ground rubber and plasticizers designed especially for alligatored and raveled areas. It is also used for filling cracks in excess of 1" in width on any asphaltic surface.



SCORPION EQUIPMENT



When impacted, the Scorpion's modular design crushes in progressive stages, which reduces the impact forces on the vehicle occupants and results in lower repair costs and easy parts replacement. The curved side rails are made from corrosion resistant aluminum tubes and offer full width impact protection along the entire length of the Scorpion II by safely redirecting the impacting vehicle away from the deadly "coffin corners" at the rear of the truck.

The integrated electric brake system comes standard on all Scorpion Trailer Attenuators and are automatically activated in the event of trailer separation or hitch failure. The Scorpion Trailer Attenuator gives full width protection to the back of the host vehicle and protects the "coffin corners" of the truck. Tested and approved for all mandatory and optional offset and angled impacts.



ROADSIDE EQUIPMENT

Roll Up Signs and Stands

- All Signs are MUTCD compliant
- When used with the correct stands, it meets the crash worthiness requirements of NCHRP-350
- Easy to use buckle on the back of the sign to slide the brace into.
- Velcro strap for storage
- Comes in 36" or 48" Reflective or Non-Reflective signs
- We carry steel and aluminum stands



Fiberglass Stands

- Swivel built into the braces
- Meets MUTCD requirements
- Perfect to use for minimal space
- Easy to remove and replace
- Makes for an easy set up within minutes
- Available sizes: 36" and 48"



Roll Up Sign Brackets

- Snap and lock design
- Allows signs without clamps to be mounted
- Easy to install onto vertical full-size stands



Big Buster

- NCHRP 350 Approved
- Can withstand heavy winds from passing trucks
- Can withstand 48"x48" rigid signs 5' off the ground
- Made from lightweight aluminum for easy transportation
- All 4 legs can be easily adjusted to sit evenly on rough terrain
- Perfect for compact storage
- Easy to use and maintain



Little Buster

- Made from steel
- Corrosion and rusting resisted due to its powder coated paint
- Dual spring mounted base adds stability with high winds and passing trucks
- All 4 legs can be easily adjusted to sit evenly on rough terrain
- Has optional flag holders
- Perfect for compact storage
- Easy to use and maintain



ROAD MAINTENANCE EQUIPMENT

Butyl Pads

Butyl adhesive pads are a quick and easy way to firmly adhere road reflectors, delineator posts, car stops, speed bumps and other traffic control devices to asphalt or concrete surfaces. Ideal where temporary mounting is required. Simply peel one of the release papers from the pad, apply the pad to the device, peel off the remaining release paper and firmly attach device to cleaned surface.



Temporary Tape

Pavement marking tapes are cold-applied, they have an advantage over sprayed or extruded materials. Pavement marking tape does not require expensive application, equipment, or experienced operators to install and require no drying or curing time.

Available in white or yellow, 4"x50 yards or 4"x100 yards.



Chip Tabs

Self-adhesive chip seal markers provide an opportunity for enormous cost savings. Quick, simple placement reduces the time that your crew is exposed to traffic. TRPMs can be installed in only seconds by one worker with no special equipment, providing high profile delineation on freshly sealed roads prior to permanent striping. Our unique adhesive system keeps the flexible TRPM securely in place. They are built tough to stand up to the high demands of maintenance work zones.



Half & Full Tracks

RPMs and Halftracks are long-term temporary road markers designed for use on both low volume roads and interstate highways, providing clear guidance to motorists both night and day.

Available to purchase in white and yellow, singles or in cases.

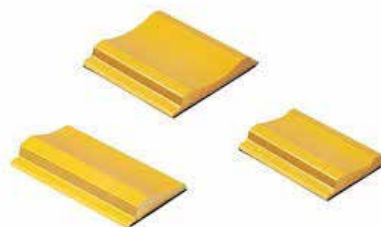

GEOTEXTILE

TerraTex Nonwoven

Designed and manufactured for construction applications. They perform the three primary functions of a geotextile: separation, reinforcement, and filtration. These geotextiles have a random, three-dimensional pore structure and are highly water-permeable. Available in various weights, lengths, and widths.



TerraTex Woven

Designed and manufactured for many construction applications. They perform the three primary functions of a geotextile: separation (separating the native subgrade from an aggregate layer); reinforcement (reinforcing an area by distributing weight over a wider area); and filtration (retaining soil while allowing the passage of water). Made of polypropylene filaments that are formed into a stable network such that they retain their relative position. Available in various weights, lengths, and widths.



Straw Wattle

Blocks debris and allows water to pass through. Filled in a net tube that is both Photodegradable and Biodegradable under aerobic and anaerobic conditions, also contains Noxious Weed Free straw. Qualified by The Department of Transportation in Oregon, Washington, and Idaho. Contains Wheat/Rye straw, and is Noxious Weed Free. Available in 9" wattle and is 25' long. Stakes sold separately.



Silt Fence Contractors Grade

A woven geotextile made up of polypropylene filaments. These filaments are woven to form a stable and durable network such that the filaments retain their relative position. It is non-biodegradable and resistant to most soil chemicals, acids, and alkali with a pH range of 3 to 12. Available in 100 feet long and 3 feet tall, with a stake every 10 feet.



CLEANERS

Citrol



Citrol Citrus Cleaner is an industrial strength degreaser formulated to remove heavy greases, carbonized oils, ink, oily deposits, tar and bituminous deposits quickly and easily. This concentrated, biodegradable, citrus-based solution is ideal for use in almost any industrial, transportation or general plant maintenance cleaning and degreasing operation.

Oil-Flo



Oil-Flo won't harm the surface, it'll just dissolve the stain to water which makes it easy to remove. Oil-Flo is a more aggressive cleaner and is used on everything from removing crayon stains to dissolving parking lots. Rinse with water. Use Oil-Flo for cleaning equipment, vehicles, applicators, tools, floors, machines, clothing, glass, steel, concrete, aluminum, and much more. It is used for any time you have a stain and you want it removed quickly and safely.

Pint and gallon are available in store, 5-gallon bucket is a special order.

Hand Cleaner 38-A



It is a heavy-duty hand cleaner designed for cleaning hands of sealcoat, asphalt, tar, oil, mastic, adhesives, pitch, grease and other tough materials. Contains ground walnut shells for gentle scrubbing; no harsh pumice. Low pleasant odor with lanolin to help keep hands soft. Cleans instantly and removes all stains from creases and finger nails; your hands will never be cleaner. Available in a pint.

FLAGS AND SIGNS

Roll-up Stop/Slow Paddles



Roll-Up stop/slow paddles offer full size paddles in a compact, lightweight, and easy to store design. Available in 18" and 24" octagons and in a variety of reflective and non-reflective materials, these kits come complete with double sided roll-up sign face, handle, and storage bag.

Stop/Slow Paddles



Rigid stop/slow paddles are available in both 18" and 24" octagon versions with reflective and non-reflective surfaces. Choose either plastic or aluminum substrates. Stop/Slow staff sold separately. Staff Extends the paddle 5' higher.

Orange Flags

Orange Flags



Solid Vinyl



Mesh

18" and 24" mesh and solid vinyl flags, blaze orange color, are available with or without 3/4" round wood staffs. Mesh flags have cloth binding.

Airport Flags



36" X 36" orange and white sewn nylon airport flag w/stitched pocket for mounting to a pole.

SIGN EQUIPMENT

Telespar



- Available in 2x2x10' 14 gauge,
2x2x12' 14 gauge
2x2x14' 14 gauge
- Perforated
- Reusable
- Versatile
- Sturdy
- Easy to use

Cross Piece Sign Holder



- Cast aluminum
- Sturdy
- Designed to hold set screws
- Weather and rain resistant
- Rust resistant
- Available in 5.5" and 12" lengths

Anchor



- 2.25"x2.25"x30", 12 gage
- Perforated
- Reusable
- Easy to use

Sign Holder



- Cast aluminum
- Slides into or onto posts
- Designed to hold set screws
- Weather and rain resistant
- Rust resistant
- Available in 5.5" and 12" lengths
- Round or square available

Telespar Mounting Plate

- Coated steel
- Great for easy installation and replacement of signs
- Weather and rain resistant



Break-A-Way Nut & Corner Bolt

- 5/16"
- Aluminum
- Threaded portion is tapered.
- Corner bolt, 2"x2", designed to attach tel-spar posts to anchors
- Upon tightening, the hex head breaks away leaving a non-removable cone



Fringe Nuts

- 5/16"
- Steel
- Locking mechanism



Aluminum Rivets

- Tamper proof
- Vibration proof
- Easy installation
- Includes nylon washer that protects the sheeting when being mounted



Bandit Brackets and Fence Mount Plate



- Install mounting washer between sign and channel post
- Prevent warping or buckling of sign
- Sold individually
- Made of aluminum
- Mounting Washer 3"x3"



- Produced and manufactured in the USA
- Stainless steel flared leg brackets are fully annealed and
- comes with stainless steel bolt (5/16", 18 thread, hex head) and washer.
- Thickness: .070"
- Tensile Strength: 55,000 PSI Minimum



THERMOPLASTIC



- Preformed Thermoplastic is engineered for enhanced visibility both day and night, durability and flexibility
- It contains uniformly distributed glass beads throughout the material
- No minimum road or air temperature requirements
- It does not require preheating to a specific temperature before application

Call for more options.

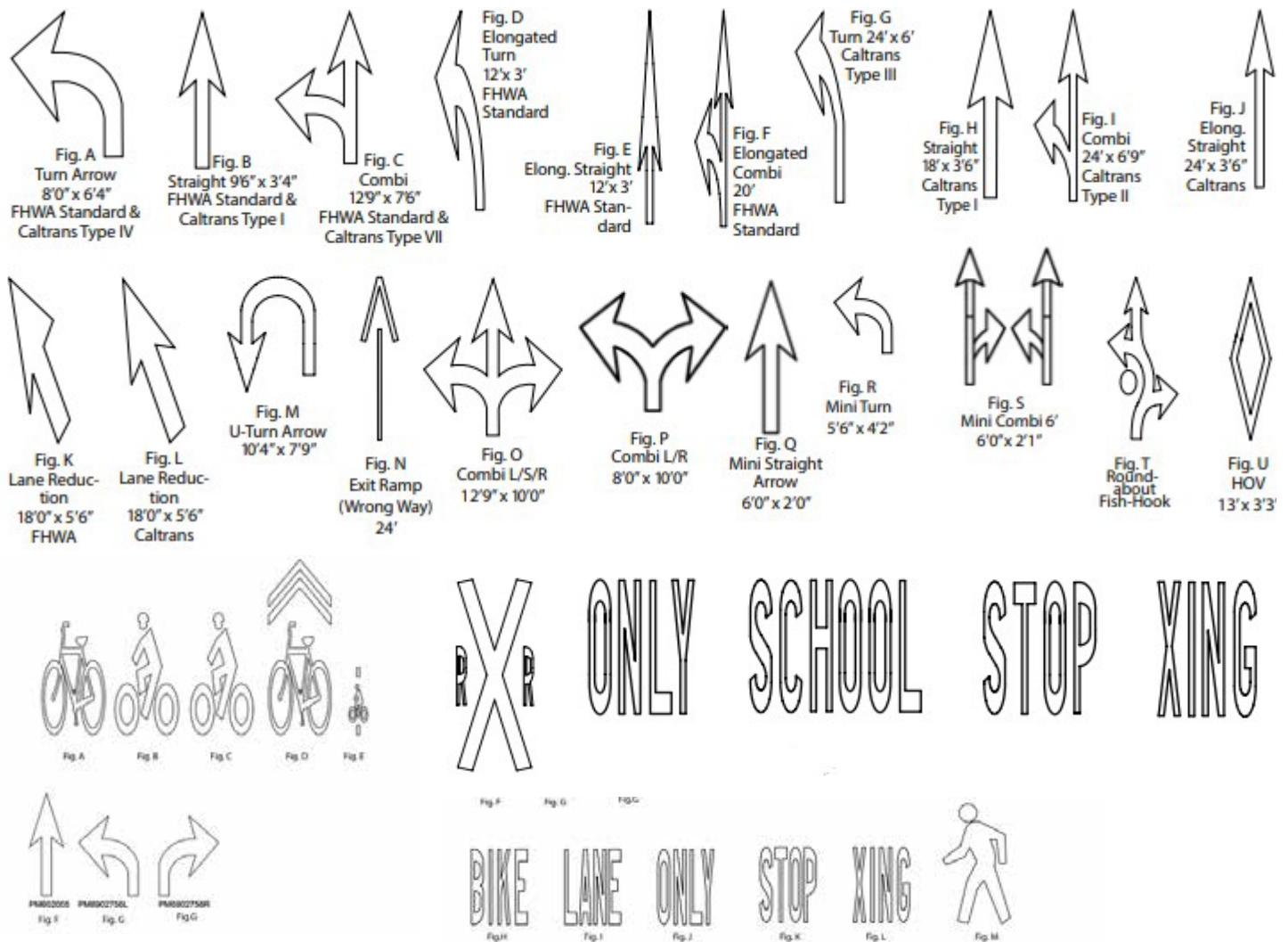

SEALCOAT

Pro-spec Asphalt Sealant with Micro Lock Technology



After investing in a compacted aggregate base and asphalt concrete, protect your investment by using a sealcoat emulsion that costs only pennies a square foot. If left alone small cracks in your asphalt pavement can quickly become expensive problems by increasing in size or causing potholes. Pro-Spec Asphalt Sealant with Micro lock technology is a water-based asphalt emulsion, that creates a sealer which will bond to your asphalt. It also contains fine aggregates to help the wear surface of the existing asphalt. Pro-Spec Asphalt Sealant is a non-toxic, non-carcinogenic and does not contain organic solvents. No hazardous fumes are given off in the curing process.

CSS-1H Tack Oil



CSS-1H is a cationic slow setting asphalt emulsion designed for use as a tack coat, base stabilization, fog sealing, dust control and specialty applications. Formulated with a harder base asphalt (lower penetration) than CSS-1, it is designed for warmer climates. Road Work Ahead Construction Supply, Inc. and Sage Supply, Inc. meets the current specification requirements of the Idaho Transportation Department.

Crack Repair



Direct and Indirect RWA crack filler is a hot applied, polymer modified crack and joint sealant for use with asphalt and concrete pavements. This product applies and sets up best in hot temperatures, and is highly durable in cold to hot climates. It is self-leveling, fast setting and quick melting. Formulated with a medium viscosity for all-round ease of application, it is ideal for highways, county roads, municipal streets, parking lots and pathways.

BROOMS

Blue Polystyrene

- Heavy gauge brush
- For wet or dry sweeping where a heavy-duty broom is required
- Recommended for rock or gravel spreading
- Available in 18" and 24"
- Can be purchased with or without a handle and brace



Brown Polypropylene

- For wet or dry sweeping
- Ideal for street and highway work
- Available in 16"
- Can be purchased with or without a handle and brace



Carbon Steel Brush

- Recommended for asphalt and concrete before applying Sealcoat
- Available in 16"
- Can be purchased with or without a handle and brace



Deck Broom

- Available in 12"
- Can be purchased with or without a handle and brace



Sealcoat Brush

- Recommended for sealant material
- Available in 24" and 36"
- Can be purchased with or without a handle and brace



Strip Broom

- Bristles wrapped around a steel rod to prevent pull out
- Comes in either heavy duty synthetic and heavy-duty natural fiber
- Available in 24", 36", and 48"
- Can be purchased with or without a handle and brace



Corn Broom

- Made with best quality broom corn and fiber
- Handle has a clear lacquered finish
- Makes it easier to spread tack oil



Handles

- Selected hardwood with clear lacquered
- Equipped with an easy to use tip
- Threaded, red tip, and silver brace, available in 60"
- Wedge handle available in 60" and 72"



SQUEEGEES

Blacktop Wood Backed

- Ideal for squeegee spreading sealcoat
- Available in 24"
- Can be purchased with or without a handle



V Squeegee

- Perfect for hot and cold crack filler
- Medium and high temperature squeegee blades available
- 6-foot handle



Straight Bladed

- Heavy-duty all aluminum
- 24", 36", 48", 60", 72" blades available
- 66" long handle
- Reinforced braces
- Can be purchased with or without handle and brace



Lute

- Magnesium lutes
- Lighter than aluminum with strength of steel
- Heavy duty brace connection
- Serrated edge with blunt points making material easy to pass through
- Handles available in 6', 7', and 8'
- Lute blades available in 24", 30", and 36"
- Braces available to fit all of our handle sizes



SHOVELS

Tamper



- Works with hot and cold patch material
- Sturdy and durable cast iron head
- Rounded edges to eliminate marks
- Available with or without a handle
- Cast iron head comes in 6" x 8", 8" x 8", and 10" x 10"

Round and Square Head Shovel



- Tempered head
- 46" Long durable handle

Jackson Round and Square Head Shovel



- Forged steel blade for maximum life
- 47" long durable handle

MISCELLANEOUS

Spray Wand



Our aluminum spray wands are lightweight and comes equipped with a quarter turn ball valve for fast and easy shut off. We manufacture and sell 7' wands with a 90-degree elbow reducer that is $\frac{3}{4}$ " on one side and $\frac{1}{2}$ " on the other. We carry spray tips in multiple sizes to meet all your sealcoating needs.

Spray Tips

Spray nozzles produce a flat, fan-shaped spray pattern, with an 80-degree angle.

80/20 in $\frac{1}{4}$ ", $\frac{3}{8}$ "
80/30 in $\frac{1}{4}$ ", $\frac{3}{8}$ "
80/50 in $\frac{1}{4}$ ", $\frac{3}{8}$ ", $\frac{1}{2}$ "
80/70 in $\frac{1}{4}$ ", $\frac{3}{8}$ ", $\frac{1}{2}$ "
Ceramic 80/70 in $\frac{3}{8}$ "
80/100 in $\frac{3}{8}$ ", $\frac{1}{2}$ "



UPM-Pot hole Patch

Cold asphalt mixes are seasonally adjusted to work in all weather, all year-round. The product can be stockpiled and used on an as-needed basis. It requires no heating and it can be loaded into trucks and taken right to the location of the needed repair. UPM cold mix requires only a shovel and the truck tires to compact it. So, no additional machinery or equipment is necessary.



Construction Fence

-4' tall warning/barrier fence at 100' per roll
-Lightweight - 12.3lbs per roll
-Mesh size 3.5"
-100% Recycled HDPE plastic



Tape

- Caution tape
- Danger tape
- 1000' x3"



All-Purpose Lube

- Lubricates and inhibits corrosion
- Silicone free
- No clumpy residue
- Cleans away dirt and grease



Highway Safety Spheres

- Cost effective nighttime roadway delineation
- Meets highway standards
- Highly durable
- Consistent in quality and composition
- Available in 50 lbs bags



Witches Hat

- Removes contaminants like litter, sand, and oil from stormwater flow
- Geotextile fabric and easy installation
- Exceeds 80% sediment removal efficiency



Quadrail

- Steel nose provides excellent visibility
- shorter systems are less likely to be impacted
- offers hazard protection from 40km/h (25 mph) to 115 km/h to (70mph)



Big Sandy Attenuator

- Available in 200, 400, 700, 1400, and 2100 lbs
- Reinforced lip prevents barrels from deforming when filled with sand.
- NCHRP 350 tested and accepted.
- Meets speeds up to 70mph



U-Channel Post

- Green baked enamel U-channel posts resists corrosion.
- Tapered end easily drives into the ground.
- 3/8" holes on 1" centers to easily attach signs



Sand Bag

- Durable construction helps prevent leaks
- Fill with sand and tie using the attached strings
- Use as a water barricade or a weight for construction signs
- Woven
- Available with or without sand



Delineator Plate

- Made of aluminum, these reflectors can be used to build a boundary near road edges, cliffs and more
- Available in White or Yellow
- 3"x3" or 3"x6"



MISCELLANEOUS CONT.

Sentry Longitudinal Energy Dissipaters

- FHWA Accepted for shielding the blunt end of concrete, steel and water filled barriers
- Quick and easy set-up, no foundation anchoring, minimized installation exposure time
- Cost effective end treatment for concrete, steel or water filled barriers
- Universal transition quickly and easily attaches to a variety of barrier shapes and sizes
- SLED's stout design virtually eliminates vaulting
- Narrow footprint is ideal for work zones or roads with minimal shoulder spacing
- Shortest length TL-3 water filled crash cushion, fewer incidental impacts
- Containment impact SLED minimizes debris field
- Visual "drive by" fill indicators quickly verify water module's are properly filled
- FHWA Accepted for use in uni- and bi- directional applications
- Internal steel cables help envelop vehicle after an impact, creating a truly "limited gating" system

TL-1

Weight	Empty 675 lbs. Filled 2505 lbs.
Length	12'7"
Width	22 ½"
Height	42"
Speed Rating	31 mph



TL-2

Weight	Empty 835 lbs. Filled 4505 lbs.
Length	18'11"
Width	11 ½"
Height	42"
Speed Rating	45 mph



TL-3

Weight	Empty 995 lbs. Filled 6505 lbs.
Length	25'3"
Width	22 ½"
Height	42"
Speed Rating	62 mph



The image shows the top portion of a snow plow. A dark, metallic surface is visible, with a red circular component in the center. In the top right corner, a white rectangular label with the word "HINIKER" in black capital letters is partially visible. The main title "HINIKER SNOW PLOW" is overlaid in large, white, bold, sans-serif capital letters.

HINIKER SNOW PLOW



TWIN FALLS SIGNS



- » MUTCD traffic signs
- » Custom signs
- » Business signs
- » Jobsite signs
- » FHWA traffic signs
- » SWPPP signs
- » Decals/stickers
- » Banners
- » Magnets

- » Cut Vinyl
- » Real Estate Signs
- » Wraps
- » Custom Swag Printing
- » Engraving
- » ADA Custom signs
- » Design Services
- » & More



208-944-9144

818 Commercial Ave. Twin Falls, ID 83301

Call, email, or visit us to place an order!

www.twinfallssigns.com



NEW ITEMS & RENTAL EQUIPMENT